

A . INSTALLATION FOR WALL HUNG LAVA

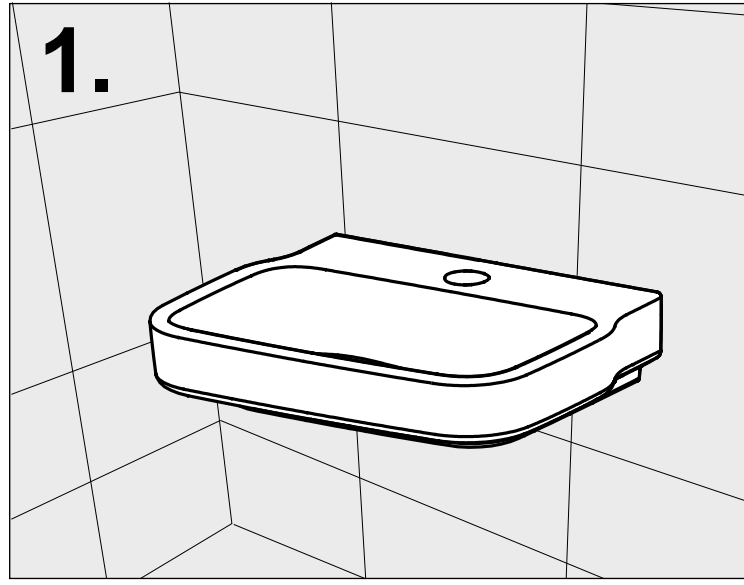

Place the lava to the installing position, mark lava screw locations through the mounting holes.

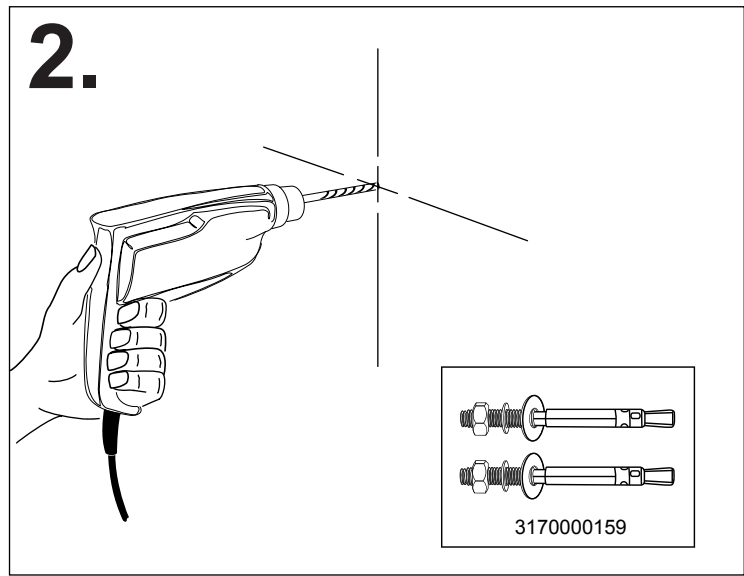

Remove lava from installed position. Drill pilot holes for bolts.

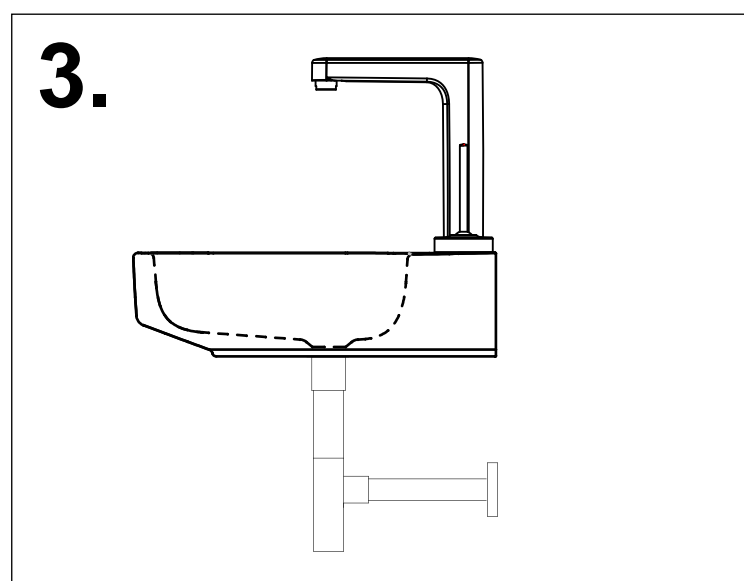

Install the overflow system and faucet, (not included in the packaging)



Install the fitted lava to the installed position by using the bolts assembly as picture shown.



Level check after installation, apply silicone sealant around the lava. (Silicone is not included in the packaging)

IDEAL DESIGN SOLUTIONS Clear counter top/wall hung lava 650mm CP-F629
 IDEAL DESIGN SOLUTIONS Dynamic counter top/wall hung lava 550mm CP-F636
 IDEAL DESIGN SOLUTIONS Dynamic counter top/wall hung lava 650mm CP-F635
 INSTALLATION TEMPLATE

These products have two kinds of installation method(counter top and wall hung lava) you can select one of them according to your actual condition.

* The product picture is only for your reference.

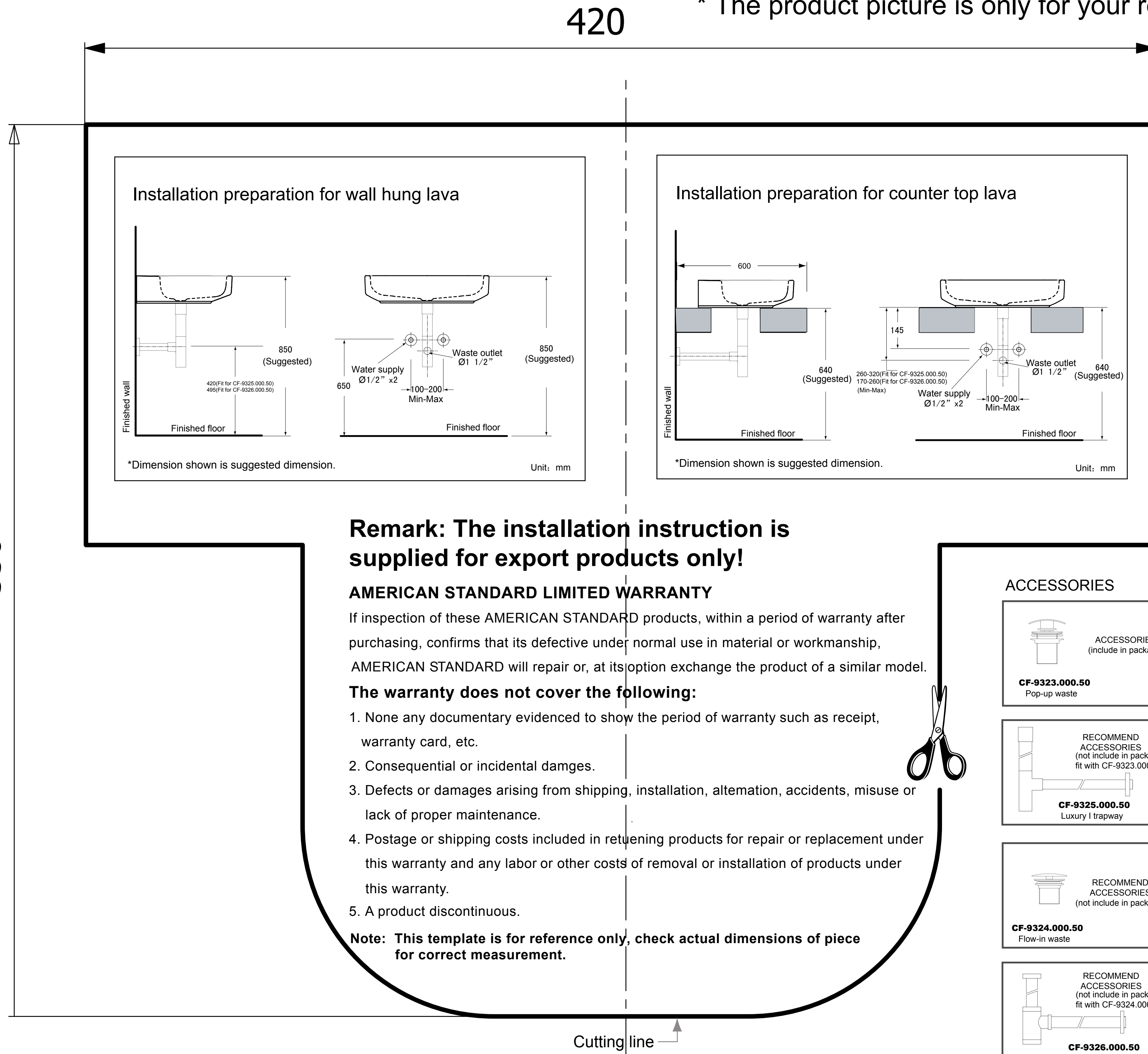

B. INSTALLATION FOR COUNTER TOP LAVA

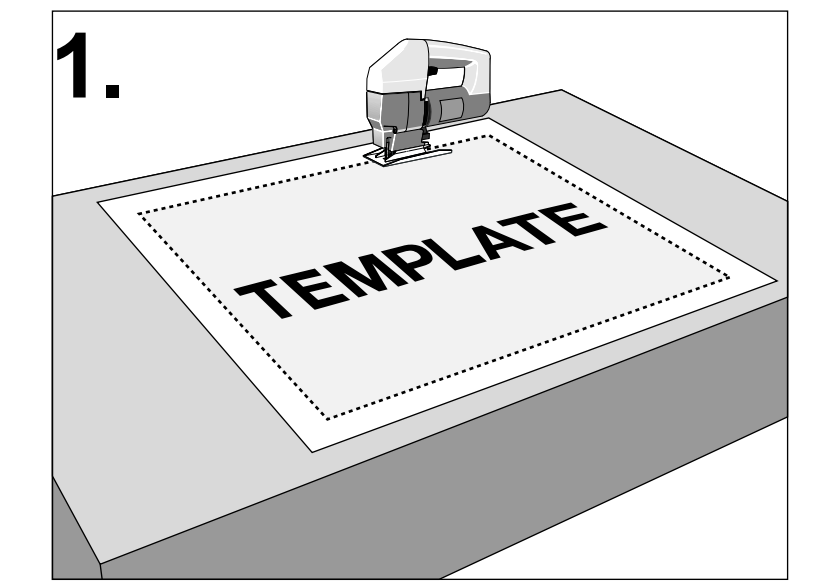

Space preparation for installation as shown. The template placing on the counter with position required following lining by punching.

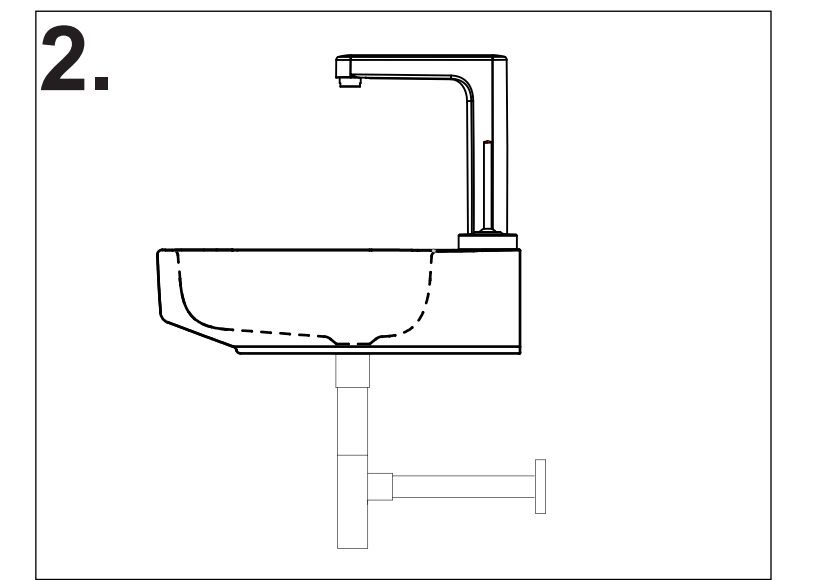

To stall faucet, water supply hose, overflow set completely install with lava.

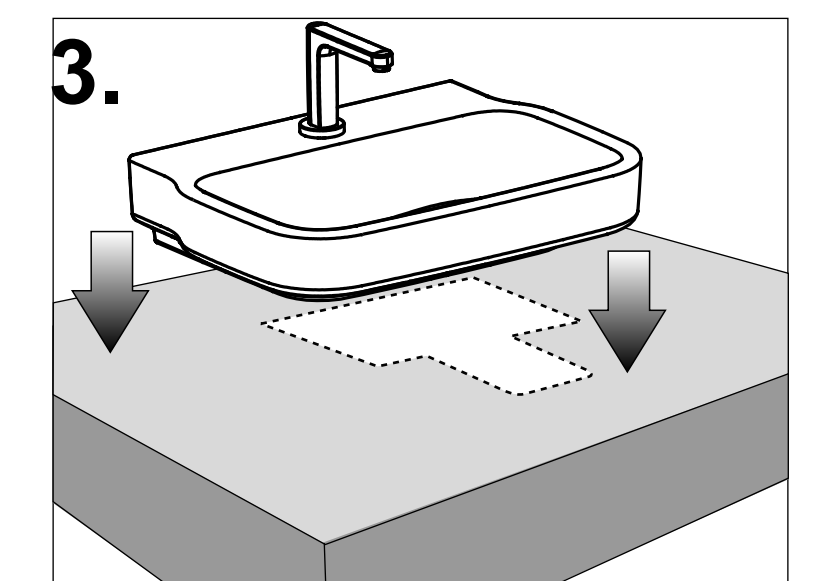

Take the lava and follow on position required.

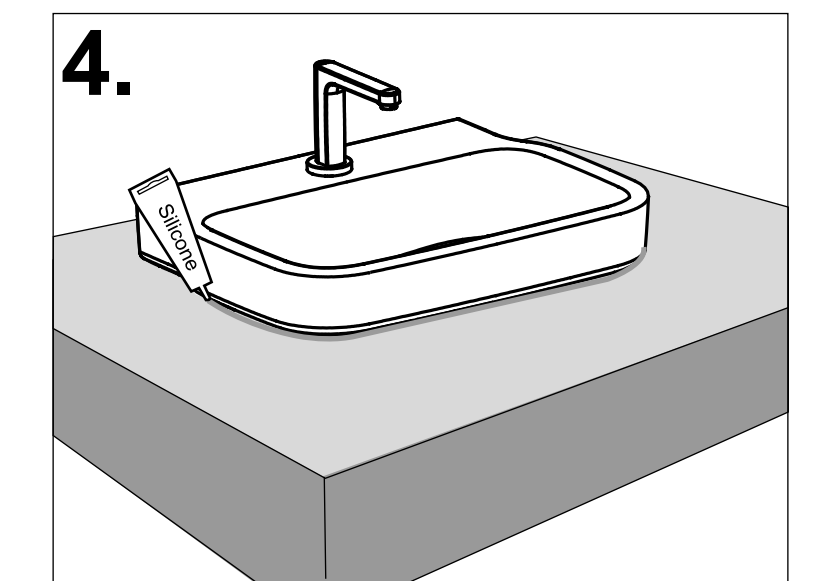

To install water supply&waste water outlet set, proper checking after finish installation, on&off water supply checking, water drianage, water leakage, if no short coming so to apply the silicone sealant around the lava rim. (Silicone is not included in the packaging)